



NOTE

Plans produced for the purpose stated below only.

This drawing is the copyright of HH CAD Plans ©

- Land Registry Plan ✓
- Marketing Plan
- Measured Survey
- Space Planning
- CAD Re-draw From Hard Copy

-  EXTENT OF DEMISED PREMISES
-  SHARED ACCESS AREA
-  BIN STORE

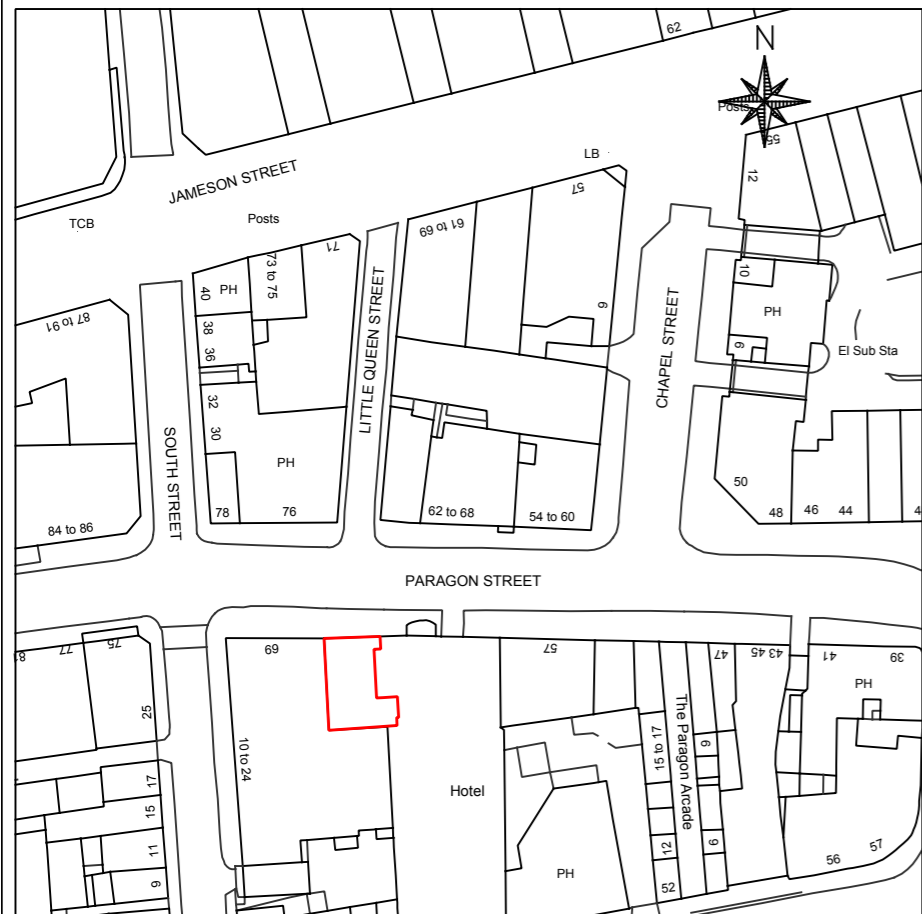

Ordnance Survey, (c) Crown Copyright 2015. All rights reserved. Licence number 100022432

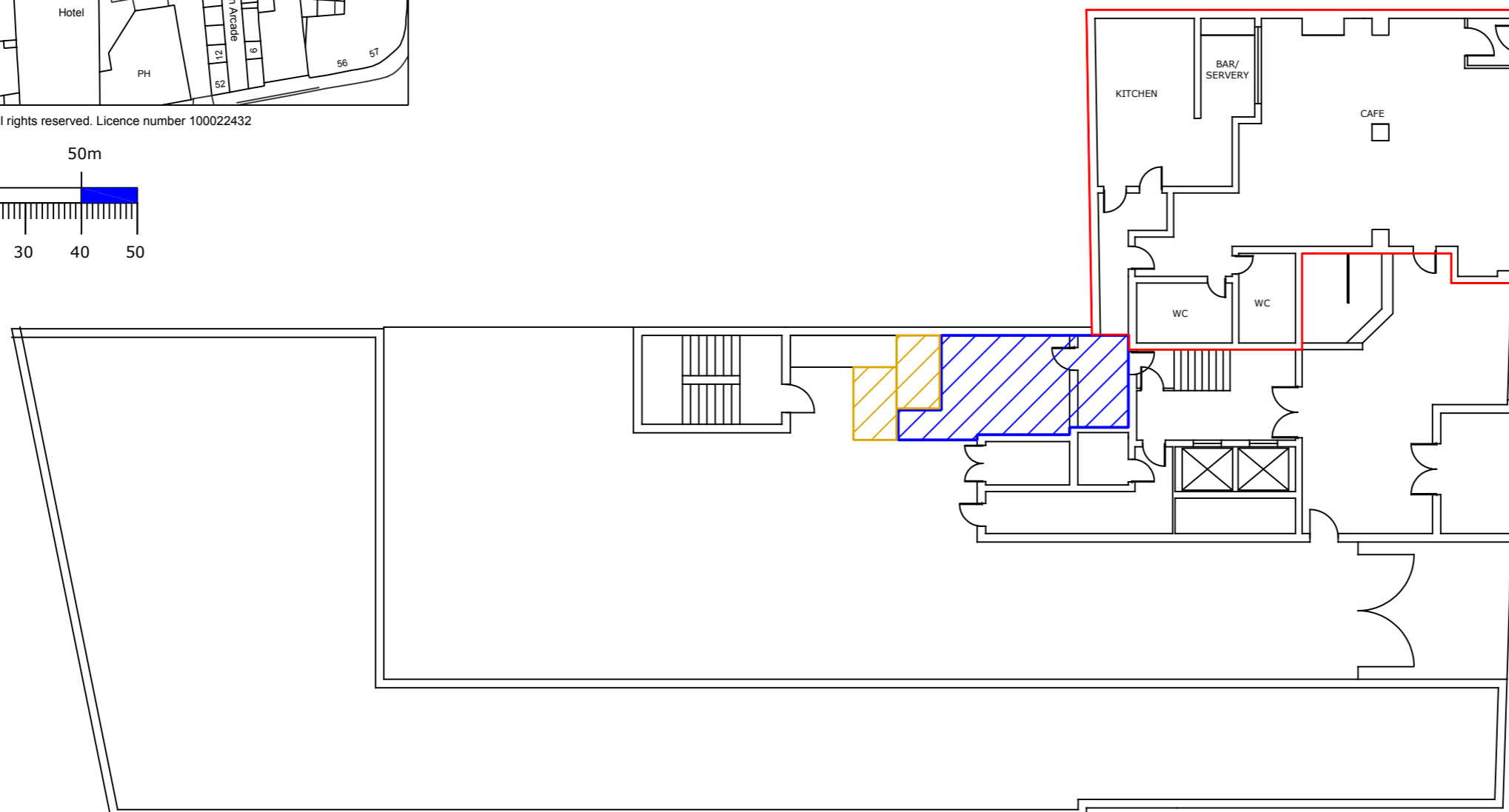
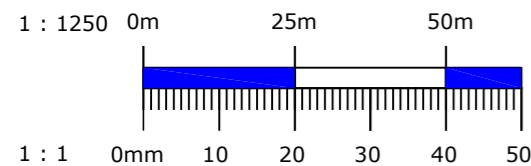

GROUND FLOOR

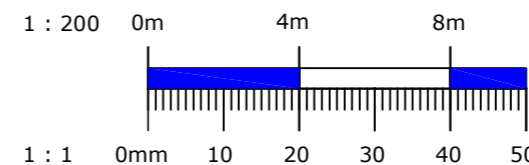

Address
 Cafe & Premises
 Ground Floor
 65 Paragon Street
 Hull, HU1 3JP

Title
 Lease Plan

Project Number
 11176

Drawing Number 50360 Revision A

Scale: 1:200 & 1:1250

Date: 29-08-17 Drawn By
 HMH

Client:
 Shelina Dhuna
 via Scotts Property